

**Sant Longowal Institute of Engineering and Technology, Longowal, Distt. Sangrur
(Deemed to be University) (Established by Govt. of India)**

Notice Inviting Tender

e-Tenders in two bid system i.e. technical bid & commercial bid for the work as mentioned below from the Firms/OEM/contractors for participating in this tender. The intending bidder should have the proof of experience of successfully completed similar works during the last 7 years ending last day of the month previously to one in which applications are invited.

The bidders should have completed at least three similar each costing not less than the amount equal to 40% or Two similar completed works, each costing not less than the amount equal to 60% or one similar completed work of costing not less than the amount equal to 80% of the estimated cost with Central Government Department/State Government Department/ Central Autonomous Body/Central Public Sector undertaking/reputed corporate/ Large private or Public educational Institutes/Hospitals/ Universities.

The intending bidder should have the following documents:

(i) Official and Residential address of the Tenderer on an affidavit duly attested by competent authority or any document containing photograph and Official & Residential address (ii) Valid license under the Contract Labour (Regulation & Abolition) Act.1970 (if applicable as per Labour laws) (iii) Proof of registration with EPFO & E.P.F. Account No. (iv) GST number (v) Proof of having carried out similar works as mentioned in para 1 above. (vi) Proof of escalation service matrix (National service head, regional service head, area service head, service leader, call centre number, e-mail id). (vii) IMA certification (viii) Last three years income tax returns. (ix) Average Annual financial turnover during last three consecutive financial years ending 31.03.2020 shall be at least 100%, 200% & 300% of the estimated cost respectively duly certified by the audited annual accounts of each year.

Sr. No.	Name of Work	Estimate Amount (Rs.)	Earnest Money Deposit (Rs.)	Cost of Tender Documents in Rs. (Non-refundable)	Tender Processing Fees (Rs.)	Time Period (Days)	Schedule of Quantities for Financial Bid (Annexure)
1	SITC of Water Purifier Plant in Boys Hostel No. 1,2 & Shopping Complex near BH-7 at SLIET Longowal	17,86,000/-	35720/-	1000/-	2107/-	120 Days	B

The tender documents will be available online only on the Institute's e-tendering website (www.tenderwizard.com/SLIET) and should also be submitted **ONLINE** through e-tendering along with tender fee of Rs.1000/- (non-refundable) and Earnest Money Deposit in favour of Director, SLIET through e-payment (IPG (Direct debit) NEFT/ OTC and Internet banking only). The tender processing fee (Non Refundable) should be paid through e-payment (debit or credit cards and internet banking).

It is mandatory for the Bidders/ Contractors to get themselves registered with www.tenderwizard.com/SLIET & get User Id, password & Class-3 Digital signatures for participating in the e-Tendering process. **For more details the bidder/contractor may contact Helpdesk of M/s ITI Limited on 0172-5035985, 9257209340, 8054628821 or mobile number-8146699866 or e-mail sliethelpdesk@gmail.com can be contacted.**

Schedule of Tender

Availability of Tenders online for Bidding		Last date of Submission for Online Bids	Date, time & venue of opening of Technical Bid	Date, time and venue of opening of Commercial bid
From	To			
10.02.2021 09:00 AM	24.02.2021 05:00 PM	24.02.2021 up to 05:00 PM	25.02.2021 at 11:00 AM in the Electrical Wing, ESS-II, Near Mechanical Block, SLIET, Longowal	03.03.2021 at 11:00 AM in the Electrical Wing, ESS-II, Near Mechanical Block, SLIET, Longowal

Contractor' sig.

Eng. In-charge

Schedule of Quantities for Technical Bid

Sr. No.	Description of item	Unit	Qty	Specifications
1	Design and SITC of Raw Water Storage Tank of 1500 Ltr capacity food grade with minimum two layer. Make Sintex(ISI),Finolex,Diplast	Nos.	2	
2	Design and SITC of Water treatment unit based on RO+UV system of capacity 500 LPH with automatic electronic control panel with suitable pump sets, , sand filters, activated carbon filter, primary & secondary cartridge, anti scalant dosing system , RO housing, elements UV steriliser of suitable capacity, flushing unit with pumps of suitable capacity and all allied accessories reqd. for the installation of the same. Raw water pump,First filter Sand vessel,Carbon Vessel, Antiscalant dosing system and tank capacity 50 LPH, Micron Cartridge filter (5 Micron,20" long), HPP, RO Membrane 4"X40" (Qty 2) and UV system. Certificates required: IMA; ISO CERTIFICATE; SERVICE ESCALATION MATRIX,OEM authorisation letter Make: EUREKA FORBES; WIPRO; THERMAX	Set	2	
3	Design and SITC of RO Water Storage Tank of 1000 Ltr capacity food grade with minimum two layer Make Sintex(ISI),Finolex,Diplast	Nos.	2	
4	SITC of Mono Block pump for water transfer from storage tank to water cooler. With Sensor & automatic System Capacity:- 0.5 H.P. Make:- Kirlosker, C.G. ABB	Nos.	2	
5	Design and SITC of Water Cooler 225/400 with Moulded drip tray, Compressor base SS, Full SS, Grade 304 and Condenser should be cover. Certificates required: ISO CERTIFICATE; SERVICE ESCALATION MATRIX. OEM authorisation letter Acceptable Make: CLIMATROL; BLUESTAR; VOLTAS.	Nos.	3	
6	Design and SITC of Waste Water Storage Tank of 1000 Ltr capacity food grade with minimum two layer Make Sintex(ISI),Finolex,Diplast	Nos.	2	
7	SITC of Insulation work for RO Water storage tank with Glass Wool and Cladding with 26 gauge Aluminium Sheet for protection and all required accessories. FOR RO water & Raw water tank	Sqf.	400	
8	Providing and fitting of Push cock Size:- 1/2" dia. ISI MARKED	Nos.	32	
9	Design and SITC of Pipes along with fittings: The pipes shall be CPVC of different diameters with pipes having working pressure of 320 PSI at 23 degrees using solvent welded CPVC fittings and CPVC cement solvent for joining of pipes. The test pressure shall be 150 PSI or 10 bar for 1 hr. The insulating material shall be of closed cell Elastomeric Nitrile rubber of thickness not less than 19 mm. The product shall have a temp. range from -40 deg c to 105 deg c and density not less than 0.06gm/cu.cm. Insulating material shall be sleeved on the pipes. All longitudinal and transverse joints shall be sealed and shall be sealed continuous over the piping and fittings. All outside pipes insulated with nitrile rubber shall be covered with Aluminum foli.			
	Size			
	a) 50 MM Dia	Rmt.	60	
	b) 25 MM Dia	Rmt.	100	
	c) 12 MM Dia	Rmt.	50	
	Make :- Astral, Prince, Finolex			

Contractor' sig.

Eng. In-charge

10	SITC of supporting material for cPVC pipe with Insulation from RO Plant to Transit Points. The horizontal pipes shall be given support at intervals of 3 feet for diameters of 1 inch and below and at 4 feet intervals for large pipes.	Lot	2	
11	Design and SITC of Drain Pipes along with fittings : PVC Pipe 19 MM DIA Make :- Astral, Prince, Finolex	Rmt.	30	
12	Providing and fixing of new SS-304/ Stainless steel water sinks/dispensing unit having thickness not less than 1.0mm and dimensions approx 21 Lenght X 1.5W X 1.5 Depth (FT)	Nos.	2	
13	Installation JOB like Loading,Unloading,Masonary,Welding,Carpenter,Fitting and plumbing with material like cement, aggregate, sand, bricks etc. as per requirement	Lot	2	
14	Supply/Fabrication/Installation of shed duly painted of approx. size 12'x12'x9' (LWH) with frame of hollow MS Square Bar (40x40x4 mm), frame of Angle iron (35x35x5mm & 25x25x3mm) covered with wire mesh having door with lock provision having concave roof of profile sheet of thickness not less than 0.45mm. Brick footing for fixing & flooring with vitrifies tiles (Tile Make: Somany, Kajaria, Nitco) as per requirement complete in all respect as desired by Engineer In-Charge.	Job	2	
15	Supply/Fabrication/Installation of shed duly painted of approx. size 5'x4'x7' (LWH) with frame of hollow MS Square Bar (40x40x4 mm), frame of Angle iron (35x35x5mm & 25x25x3mm) covered with wire mesh having door with lock provision having concave roof of profile sheet of thickness not less than 0.45mm. Brick footing for fixing & flooring with vitrifies tiles (Tile Make: Somany, Kajaria, Nitco) as per requirement complete in all respect as desired by Engineer In-Charge.	Job	1	
16	Providing/Hoisting & Fixing of RCC Slab (1:2:3) of approx. size 10'x10'x4.5" (LWH) including iron bar of 12mm dia in 6" x 6" Box.	Job	2	
17	Providing and fixing following rating and breaking capacity and pole MCCB with thermomagnetic release and terminal spreaders in existing cubicle panel board including drilling holes in cubicle panel, making connections, etc. as required. 100 A, 16 KA,TPMCCB	Each	4	
18	Supplying and making end termination with brass compression gland and aluminium lugs for following size of PVC insulated and PVC sheathed / XLPE aluminium conductor cable of 1.1 KV grade as required. 3½ X 25 sq. mm (28mm)	Each	4	
19	Laying and fixing of one number PVC insulated and PVC sheathed / XLPE power cable of 1.1 KV grade of following size on wall surface as required. Upto 35 sq. mm (clamped with 1mm thick saddle)	Mtr.	100	
20	Supply of Aluminium, Armoured PVC insulated and PVC sheathed / XLPE LT power cable 4C of 25 square mm 1.1KV grade as per IS 7098 (Part-1) 1988 etc. as per requirement. Make: KEI, L&T, Havells, Polycab, Alcon	Mtr.	100	

Contractor' sig.

Eng. In-charge

Schedule of Quantities for Financial Bid

Sr. No.	Description of item	Unit	Qty	Rate (Rs.)	Amount (Rs.)
1	Design and SITC of Raw Water Storage Tank of 1500 Ltr capacity food grade with minimum two layer. Make Sintex(ISI),Finolex,Diplast	Nos.	2		
2	Design and SITC of Water treatment unit based on RO+UV system of capacity 500 LPH with automatic electronic control panel with suitable pump sets, , sand filters, activated carbon filter, primary & secondary cartridge, anti scalant dosing system , RO housing, elements UV steriliser of suitable capacity, flushing unit with pumps of suitable capacity and all allied accessories reqd. for the installation of the same. Raw water pump,First filter Sand vessel,Carbon Vessel, Antiscalant dosing system and tank capacity 50 LPH, Micron Cartridge filter (5 Micron,20" long), HPP, RO Membrane 4"X40" (Qty 2) and UV system. Certificates required: IMA; ISO CERTIFICATE; SERVICE ESCALATION MATRIX,OEM authorisation letter Make: EUREKA FORBES; WIPRO; THERMAX	Set	2		
3	Design and SITC of RO Water Storage Tank of 1000 Ltr capacity food grade with minimum two layer Make Sintex(ISI),Finolex,Diplast	Nos.	2		
4	SITC of Mono Block pump for water transfer from storage tank to water cooler. With Sensor & automatic System Capacity:- 0.5 H.P. Make:- Kirlosker, C.G. ABB	Nos.	2		
5	Design and SITC of Water Cooler 225/400 with Moulded drip tray, Compressor base SS, Full SS, Grade 304 and Condenser should be cover. Certificates required: ISO CERTIFICATE; SERVICE ESCALATION MATRIX. OEM authorisation letter Acceptable Make: CLIMATROL; BLUESTAR; VOLTAS.	Nos.	3		
6	Design and SITC of Waste Water Storage Tank of 1000 Ltr capacity food grade with minimum two layer Make Sintex(ISI),Finolex,Diplast	Nos.	2		
7	SITC of Insulation work for RO Water storage tank with Glass Wool and Cladding with 26 gauge Aluminium Sheet for protection and all required accessories. FOR RO water & Raw water tank	Sqf.	400		
8	Providing and fitting of Push cock Size:- 1/2" dia. ISI MARKED	Nos.	32		
9	Design and SITC of Pipes along with fittings: The pipes shall be CPVC of different diameters with pipes having working pressure of 320 PSI at 23 degrees using solvent welded CPVC fittings and CPVC cement solvent for joining of pipes. The test pressure shall be 150 PSI or 10 bar for 1 hr. The insulating material shall be of closed cell Elastomeric Nitrile rubber of thickness not less than 19 mm. The product shall have a temp. range from -40 deg c to 105 deg c and density not less than 0.06gm/cu.cm. Insulating material shall be sleeved on the pipes. All longitudinal and transverse joints shall be sealed and shall be sealed continuous over the piping and fittings. All outside pipes insulated with nitrile rubber shall be covered with Aluminum foli.				
	Size				
	a) 50 MM Dia	Rmt.	60		
	b) 25 MM Dia	Rmt.	100		
	c) 12 MM Dia	Rmt.	50		
	Make :- Astral, Prince, Finolex				

Contractor' sig.

Eng. In-charge

10	SITC of supporting material for cPVC pipe with Insulation from RO Plant to Transit Points. The horizontal pipes shall be given support at intervals of 3 feet for diameters of 1 inch and below and at 4 feet intervals for large pipes.	Lot	2		
11	Design and SITC of Drain Pipes along with fittings : PVC Pipe 19 MM DIA Make :- Astral, Prince, Finolex	Rmt.	30		
12	Providing and fixing of new SS-304/ Stainless steel water sinks/dispensing unit having thickness not less than 1.0mm and dimensions approx 21 Lenght X 1.5W X 1.5 Depth (FT)	Nos.	2		
13	Installation JOB like Loading,Unloading,Masonary,Welding,Carpenter,Fitting and plumbing with material like cement, aggregate, sand, bricks etc. as per requirement	Lot	2		
14	Supply/Fabrication/Installation of shed duly painted of approx. size 12'x12'x9' (LWH) with frame of hollow MS Square Bar (40x40x4 mm), frame of Angle iron (35x35x5mm & 25x25x3mm) covered with wire mesh having door with lock provision having concave roof of profile sheet of thickness not less than 0.45mm. Brick footing for fixing & flooring with vitrifies tiles (Tile Make: Somany, Kajaria, Nitco) as per requirement complete in all respect as desired by Engineer In-Charge.	Job	2		
15	Supply/Fabrication/Installation of shed duly painted of approx. size 5'x4'x7' (LWH) with frame of hollow MS Square Bar (40x40x4 mm), frame of Angle iron (35x35x5mm & 25x25x3mm) covered with wire mesh having door with lock provision having concave roof of profile sheet of thickness not less than 0.45mm. Brick footing for fixing & flooring with vitrifies tiles (Tile Make: Somany, Kajaria, Nitco) as per requirement complete in all respect as desired by Engineer In-Charge.	Job	1		
16	Providing/Hoisting & Fixing of RCC Slab (1:2:3) of approx. size 10'x10'x4.5" (LWH) including iron bar of 12mm dia in 6" x 6" Box.	Job	2		
17	Providing and fixing following rating and breaking capacity and pole MCCB with thermomagnetic release and terminal spreaders in existing cubicle panel board including drilling holes in cubicle panel, making connections, etc. as required. 100 A, 16 KA,TPMCCB	Each	4		
18	Supplying and making end termination with brass compression gland and aluminium lugs for following size of PVC insulated and PVC sheathed / XLPE aluminium conductor cable of 1.1 KV grade as required. 3½ x 25 sq. mm (28mm)	Each	4		
19	Laying and fixing of one number PVC insulated and PVC sheathed / XLPE power cable of 1.1 KV grade of following size on wall surface as required. Upto 35 sq. mm (clamped with 1mm thick saddle)	Mtr.	100		
20	Supply of Aluminium, Armoured PVC insulated and PVC sheathed / XLPE LT power cable 4C of 25 square mm 1.1KV grade as per IS 7098 (Part-1) 1988 etc. as per requirement. Make: KEI, L&T, Havells, Polycab, Alcon	Mtr.	100		
Total (Rs.)					

Contractor' sig.

Eng. In-charge

1. The Contractors should quote in figures as well as in word the rates and amount tendered by them. The amount for each item should be worked out the requisite totals given.
2. i) An item rate tender containing percentage below/above will be summarily rejected. However where a quotation voluntarily offers a rebate, this may be considered.
ii) Quotations shall be strictly as per the condition of work, conditional quotations are liable to be rejected.
3. i) Special care should be taken to write the rate and amounts in figures as well as in words in such a way that interpolation is not possible. The total amount should be written before the figure of Rupees and word paisa should be written at the end (unless the rates in whole rupees) and followed by the word only. It should invariably be upto two decimal places. While quoting the rates in schedule of quantities, the word only should be written closely following the amount and it should not be written in the next line.
ii) In case of any discrepancy between the rates quoted in figures and words that rate on which the amount has been worked out shall be taken as correct. In case of any discrepancy between the rate quoted and the amount worked out the rate quoted in figures and words shall be taken as correct.
4. The quotation for works shall remain open for acceptance for a period of ninety days from date of opening of tenders. If any contract withdraws his quotation before the said period or makes any modification in the terms and conditions of the quotation which are not acceptable to the Institute.
5. The acceptance of a tender will rest with the Director, SLIET who does not bind himself to accept the lowest quotation, and reserves to himself the authority to reject any or all of the quotations received without the assignment of any reason. All quotations in which any of the prescribed conditions are not fulfilled or are incomplete in any respect are liable to be rejected.
6. On acceptance of the quotation, the name of the accredited representative(s) of the contractor who would be responsible for taking instructions from the Engineer-in-charge shall be intimated to the undersigned.

7. Security Deposit

10% will be deducted from each RA bill of contractor as a security deposit subject to maximum 5% of the contract value. This will be released after satisfactory completion of defect liability period (which is one year from the date of completion of work) & completion of all contractual obligations, submission of relevant complete documents and NOC from Labour Commissioner.

In case contractor claims first & final bill, the bidder has to submit performance security @5% of contract value subject to minimum 5000/- in the form of BG/FD/DD favouring Director SLIET Longowal valid upto defect liability period. This will be release after satisfactory completion of defect liability period and completion of all contractual obligations on the submission of all relevant documents.

8. The EMD shall be refunded to the successful bidder beyond 60 days after the successful completion of work upto the entire satisfaction of Engineer In-Charge & on the submission of Performance Security/Security Deposit whichever is eariler.
9. The contractor shall also ensure compliance of the EPF & MP Act, 1952 by the Sub-contractor, if any engaged by the contractor for the said work and any sub-contractor engaged should also have Provident Fund Code.
10. Canvassing in connection with quotation is strictly prohibited and the quotation submitted by the contractors who resort to canvassing will be liable to rejection.
11. The Contractor shall not be permitted to quotation for work in the SLIET responsible for award and execution of contractors in which his near relative is posted as Accountant or as an Officer in any capacity between the grades of Faculty In-charge (Electrical) and Assistant Engineer (both inclusive). He shall also intimate the names of persons who are working with in any capacity or are subsequently employed by him and who are near relatives to any of the officers in the Institute. Any breach of this condition by the Contractor would render him liable to be removed from the approved list of contractors of this Institute.
12. GST or any other tax on material in respect of the contract shall be payable by the contractor and Institute will not entertain any claim whatsoever.
13. In case of non-availability of ESIC Scheme in the region, the same shall be covered under the Workman Compensation Act (WCA) or Group Insurance Scheme by the Contractor.
14. The payment will be made within 30 days after completion of work & on the submission of Tax invoice with GST no, RTGS/NEFT bank detail & other relevant documents (if any) subject to the fully satisfaction of the department about the quality of work.

Contractor' sig.

Eng. In-charge

DRAWING

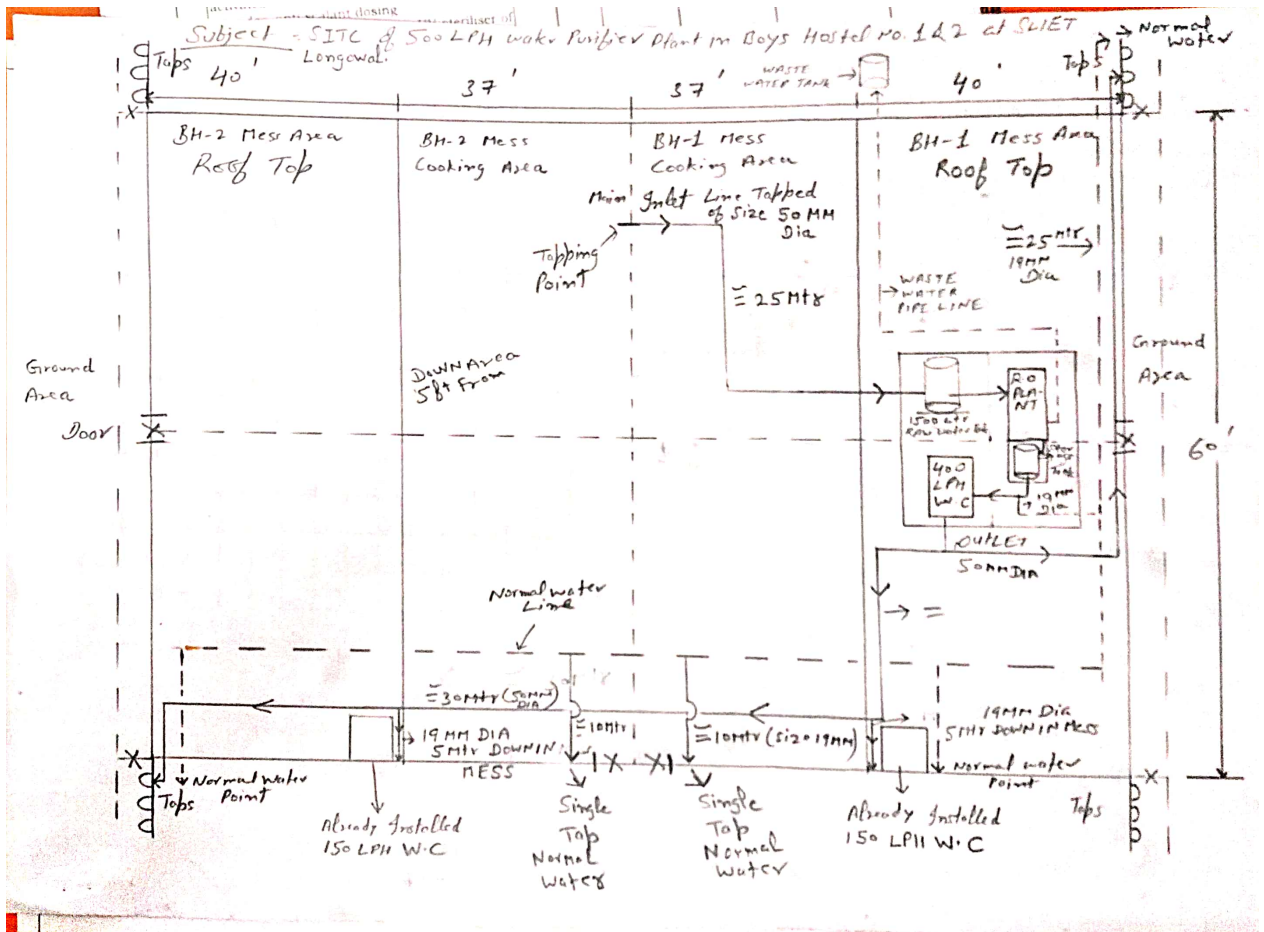

Contractor' sig.

Eng. In-charge

Subject: SITS of 500LPH water Purifier Plant on the roof of shopping Complex Near BH-7 Ground.

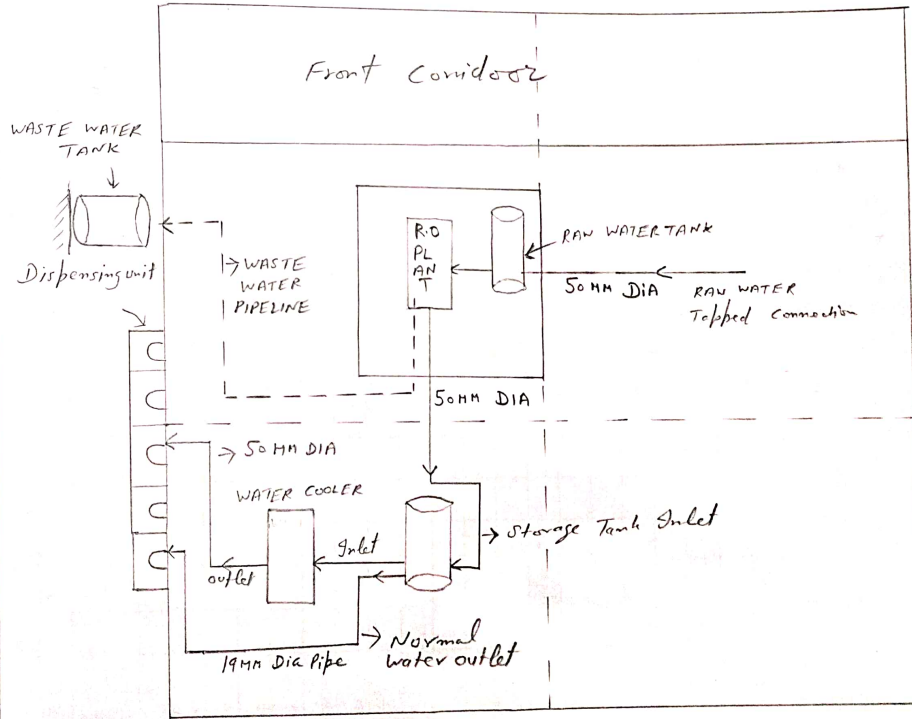

Contractor' sig.

Eng. In-charge