

**Sant Longowal Institute of Engineering and Technology, Longowal, Distt. Sangrur  
(Deemed to be University) (Established by Govt. of India)**

**Notice Inviting Tender**

e-Tenders in two bid system i.e. technical bid & commercial bid for the work as mentioned below from the Firms/OEM/contractors for participating in this tender. The intending bidder should have the proof of experience of successfully completed similar works (SITC of Audio/Video system) during the last 7 years ending last day of the month previously to one in which applications are invited.

The bidders should have completed at least three similar each costing not less than the amount equal to 40% or Two similar completed works, each costing not less than the amount equal to 60% or one similar completed work of costing not less than the amount equal to 80% of the estimated cost with Central Government Department/State Government Department/ Central Autonomous Body/Central Public Sector undertaking/reputed corporate/ Large private or Public educational Institutes/Hospitals/ Universities.

The intending bidder should have the following documents:

(i) Official and Residential address of the Tenderer on an affidavit duly attested by competent authority or any document containing photograph and Official & Residential address (ii) Valid license under the Contract Labour (Regulation & Abolition) Act.1970 (if applicable as per Labour laws) (iii) Proof of registration with EPFO & E.P.F. Account No. (iv) GST number (v) Proof of having carried out similar works as mentioned in para 1 above. (vi) Last three years income tax returns. (vii) Average Annual financial turnover during last three consecutive financial years ending 31.03.2020 shall be at least 100%, 200% & 300% of the estimated cost respectively duly certified by the audited annual accounts of each year.

Sr. No.	Name of Work	Estimate Amount (Rs.)	Earnest Money Deposit (Rs.)	Cost of Tender Documents in Rs. (Non-refundable)	Tender Processing Fees (Rs.)	Time Period (Days)	Schedule of Quantities for Financial Bid (Annexure)
1	SITC of Audio and Video system in JC Bose Hall (ISTE Hall) at SLIET Longowal	15,25,500/-	30,510/-	1000/-	1800/-	90 Days	B

The tender documents will be available online only on the Institute's e-tendering website ([www.tenderwizard.com/SLIET](http://www.tenderwizard.com/SLIET)) and should also be submitted **ONLINE** through e-tendering along with tender fee of Rs.1000/- (non-refundable) and Earnest Money Deposit in favour of Director, SLIET through e-payment (IPG (Direct debit) NEFT/ OTC and Internet banking only). The tender processing fee (Non Refundable) should be paid through e-payment (debit or credit cards and internet banking).

It is mandatory for the Bidders/ Contractors to get themselves registered with [www.tenderwizard.com/SLIET](http://www.tenderwizard.com/SLIET) & get User Id, password & Class-3 Digital signatures for participating in the e-Tendering process. **For more details the bidder/contractor may contact Helpdesk of M/s ITI Limited on 0172-5035985, 9257209340, 8054628821 or mobile number-8146699866 or e-mail [sliethelpdesk@gmail.com](mailto:sliethelpdesk@gmail.com) can be contacted.**

**Schedule of Tender**

Availability of Tenders online for Bidding		Last date of Submission of Online Bids	Date, time & venue of opening of Technical Bid	Date, time and venue of opening of Commercial bid
From	To			
18.08.2020 09:00 AM	14.09.2020 03:00 PM	14.09.2020 up to 05:00 PM	15.09.2020 at 11:00 AM in the Electrical Wing, ESS-II, Near Mechanical Block, SLIET, Longowal	16.09.2020 at 11:00 AM in the Electrical Wing, ESS-II, Near Mechanical Block, SLIET, Longowal

**Contractor' sig.**

**Eng. In-charge**

## Schedule of Quantities for Technical Bid

Sr. No.	Description of item	Unit	Qty	Specifications
1	SMART DIGITAL PODIUM SITC of Smart Digital Podium - Consist of Controller for Projector On/Off and Motorised Screen Up/Down Cum Switcher for switching between PC/Laptop/Visualizer in the Podium for the output to the Screen. USB Port – for Pen Drive, Power Plug for Laptop. Comes with Desktop with Specifications are Processor i3 8th Gen, 4GB, 1TB HDD, Pre loaded Win 10 Pro & 22" Interactive Monitor with Motorised Angle Adjustment. with inbuild storage place under lock & key, space for Key/board mouse, Visualiser & Laptop with sliding top. With Cabling and Wiring Make: ALTOP/BRIO/ATDSC	Each	1	
2	UPS SITC of Back-UPS 6000VA With 16 X 26 AH Battery with Selectable Charger and Flooded/SMF Compatible Efficiency 92% (at 100% load). Crest Factor 3:1, Built-in Automatic Bypass, Power Chute Software. Input Frequency 40-70Hz. Input voltage for main operations 160-285V Make: EATON / VERTIV LIEBERT / APC	Each	1	
3	Projector RGB liquid crystal shutter projection system. Native XGA (1,024x768) resolution with 4000 lumens, 2 HDMI Ports. Auto power saving with brightness adjustment and lamp dimming,Wifi presentation with optional dongle, 2 years warranty Make: Sony/Panasonic/Epson	Each	2	
4	Projector Screen SITC of Motorized projector screen size 12ft*9ft Matt White Fabric,Tubular Motor, Octagonal Casing, with RF Remote Make: Liberty/Truvision/Lee Grand	Each	2	
5	Projector Mount kit SITC of 6ft Adjustable / Max. load Capacity - 8 kg / tilt: 15 degrees / Adjustable. Cable can be put through the drop pole. Make: Lee Grand/Liberty/ELCOR	Each	2	
6	20 Meter HDMI CABLE Supplying & Laying of HDMI version 1.4 male to male cable,24K gold plated connector resists High purity oxygen free copper Make: Honeywell / MX /Stecker	Each	1	
7	30 Meter HDMI CABLE Supplying & Laying of HDMI version 1.4 male to male cable,24K gold plated connector resists High purity oxygen free copper Make: Honeywell / MX /Stecker	Each	1	

Contractor' sig.

Eng. In-charge

8	25 Meter HDMI CABLE Supplying & Laying of HDMI version 1.4 male to male cable,24K gold plated connector resists High purity oxygen free copper Make: Honeywell / MX /Stecker	Each	1	
9	2 Meter HDMI CABLE Supplying & Laying of HDMI version 2.0 male to male cable,24K gold plated connector resists ,High purity oxygen free copper Make: Honeywell / MX /Stecker	Each	1	
10	HDMI Switcher Supplying & Fixing of HDMI 2 in 4 out Audio Switcher Make: Milestone/Kramer/Extron	Each	1	
11	SPEAKERS SITC of 80 Watt, Slim Column array with 16x1.5" driver YAMAHA/JBL/STUDIOMASTER	Each	2	
12	AMPLIFIER SITC of 2ch, 1050W with EQ, filter, crossover, delay Make: YAMAHA/CROWN/STUDIOMASTER	Each	1	
13	AMPLIFIER SITC of 2ch, 800W with EQ, filter, crossover, delay Make: YAMAHA/CROWN/STUDIOMASTER	Each	1	
14	CROSSOVER SITC of 2-WAY ACTIVE STEREO CROSSOVER. CROSSOVER SELECTABLE FREQUENCY : 60,90,120,200 & 280 Hz. Make: STUDIOMASTER	Each	1	
15	SubWoofers/Base SITC of 1020W, 12" powered Sub Woofer, 800 Watt Active Sub Woofer, 134 db peak Make: YAMAHA/JBL/STUDIOMASTER	Each	1	
16	STAGE MONITOR SITC of Stage monitor with 15" powered speaker, 2 way full range, FR 46 Hz - 20kHz Make: YAMAHA/JBL/STUDIOMASTER	Each	2	
17	MIXER SITC of 16 CH, 6 Mic/12 line input (4 mono + 4 stereo/2 griup buses+1 stereo bus/2 Aux) YAMAHA/SOUNDCRAFT/STUDIOMASTER	Each	1	
18	GOOSENECK MIC Supplying & Fixing of 21" Gooseneck MIC, Cardioid, Electret condenser, Frequeny Response - 20Hz-20KHz, Sensitivity - - 40dB, Anti Mobile & RFTechnology Interference Make: AKG/STUDIOMASTER/SENNHEISER	Each	1	
19	WIRELESS MIC HANDHELD Supplying & Fixing of UHF Handheld Wireless Cardioid MIC, Frequeny Response - 50Hz-16KHz, Balanced XLR Unbalanced 1/4" Jack Make: AKG/STUDIOMASTER/SENNHEISER	Each	2	
20	WIRELESS MIC LAPEL Supplying & Fixing of UHF Lapel Wireless Cardioid MIC, Frequeny Response - 50Hz-16KHz, Balanced XLR Unbalanced 1/4" Jack Make: AKG/STUDIOMASTER/SENNHEISER	Each	6	

Contractor' sig.

Eng. In-charge

21	HEAD BAND Supplying & Fixing of Headset microphone, Uni-directional pick up pattern, Sensitivity $-44 \pm 2\text{dB}$ (6.3mV/Pa), Frequency Response 20Hz-20KHz, Nominal Impedence 2.2K $\Omega$ . Make: AHUJA/STUDIOMASTER/AKG	Each	6	
22	WIRED MIC Supplying & Fixing of Dynamic super-cardioid microphone for speech and vocals, Suspended cartridge shock-mount system, Frequency Response - 50Hz-15kHz, Sensitivity - $-50\text{dB} \pm 3\text{dB}$ , Nominal Impedence 350 $\Omega$ Make: AKG/STUDIOMASTER/SENNHEISER	Each	6	
23	BRANDED MIC STAND Supplying & Fixing of Floor Stand, Powder Coated, Height 920-1500mm	Each	6	
24	SPEAKER WIRE - ROLLS Supplying & laying of 102/40 ABC 2/CORE Make: FALCON / KRYSTALS / KLOTZ	Roll	2	
25	ACCESSORIES Supplying & Fixing of Jack , Connector, Mic wire, uPVC trunking, stand for stage monitor & speakers Etc. as per requirement. Make: NEUTRIK/PPX/SR	Job	1	
26	Labor & Installation Charges	Job	1	
27	Providing and fixing aluminium work for doors, windows, ventilators and partitions with extruded built up standard tubular sections/ appropriate Z sections and other sections of approved make conforming to IS: 733 and IS: 1285, fixing with dash fasteners of required dia and size, including necessary filling up the gaps at junctions, i.e. at top, bottom and sides with required EPDM rubber/neoprene gasket etc. Aluminium sections shall be smooth, rust free, straight, mitred and jointed echanically wherever required including cleat angle, Aluminium snap beading for glazing / paneling, C.P. brass / stainless steel screws, all complete as per architectural drawings and the directions of Engineer-in-charge. (Glazing, paneling and dash fasteners to be paid for separately) : For fixed portion Powder coated aluminium (minimum thickness of powder coating 50 micron)	KG	45	
28	For shutters of doors, windows & ventilators including providing and fixing hinges/ pivots and making provision for fixing of fittings wherever required including the cost of EPDM rubber / neoprene gasket required (Fittings shall be paid for separately)  Powder coated aluminium (minimum thickness of powder coating 50 micron)	KG	12	
29	Providing and fixing 12 mm thick prelaminated particle board flat pressed three layer or graded wood particle board conforming to IS: 12823 Grade I Type II, in panelling fixed in aluminum doors, windows shutters and p artition frames with C.P . brass / stainless steel screwsetc. complete as per architectural drawings and directions of engineer-in-charge. Pre-laminated particle board with decorative lamination on both sides	Sqm	1.48	

Contractor' sig.

Eng. In-charge

30	Providing and fixing glazing in aluminium door, window, ventilator shutters and partitions etc. with EPDM rubber / neoprene gasket etc. complete as per the architectural drawings and the directions of engineer-in-charge. (Cost of aluminium snap beading shall be paid in basic item): With float glass panes of 5 mm thickness (weight not less than 12.50 kg/ sqm)	Sqm	2.25	
31	Providing and fixing Brass 100mm mortice latch and lock with 6 levers without pair of handles (best make of approved quality) for aluminium doors including necessary cutting and making good etc. complete.	Each	1	
32	Providing and fixing aluminium tower bolts, ISI marked, anodised (anodic coating not less than grade AC 10 as per IS : 1868 ) transparent or dyed to required colour or shade, with necessary screws etc. complete 150x10 mm	Each	2	
33	Providing and fixing aluminium hanging floor door stopper, ISI marked, anodised (anodic coating not less than grade AC 10 as per IS : 1868) transparent or dyed to required colour and shade, with necessary screws etc. complete. Twin rubber stopper	Each	1	
34	Supplying and laying of following size DWC HDPE pipe ISI marked along with all accessories like socket, bend, couplers etc. conforming to IS 14930, Part II complete with fitting and cutting, jointing etc. direct in ground (75 cm below ground level) including excavation and refilling the trench but excluding sand cushioning and protective covering etc., complete as required. 63 mm dia (OD-63 mm & ID-51 mm nominal)	Mtr.	50	
35	Laying of one number PVC insulated and PVC sheathed / XLPE power cable of 1.1 KV grade of following size in the existing RCC/ HUME/ METAL pipe as required. Upto 35 sq. mm	Mtr.	50	
36	Providing and fixing following rating and breaking capacity and pole MCCB with thermomagnetic release and terminal spreaders in existing cubicle panel board including drilling holes in cubicle panel, making connections, etc. as required. 100 A, 16 KA, TPMCCB	Each	1	
37	Supplying and fixing following way, horizontal type three pole and neutral, sheet steel, MCB distribution board, 415 V, on surface/ recess, complete with tinned copper bus bar, neutral bus bar, earth bar, din bar, interconnections, powder painted including earthing etc. as required. (But without MCB/RCCB/Isolator) 4 way (4 + 12), Double door	Each	2	
38	Supplying and fixing 5 A to 32 A rating, 240/415 V, 10 kA, "C" curve, miniature circuit breaker suitable for inductive load of following poles in the existing MCB DB complete with connections, testing and commissioning etc. as required. a) Single pole	Each	24	
	b) Double pole	Each	1	
39	Supplying and fixing 30 A, 415 V, TPN Industrial type socket outlet, with 4 pole and earth, metal enclosed plug top alongwith 30 A "C" curve, TPMCB, in sheet steel enclosure, on surface or in recess, with chained metal cover for the socket out let and complete with connections, testing and commissioning etc. as required.	Each	2	

Contractor' sig.

Eng. In-charge

40	Supplying and fixing DP sheet steel enclosure on surface/ recess along with 25/32 A 240 V "C" curve DP MCB complete with connections, testing and commissioning etc. as required.	Each	3	
41	Supplying and drawing of UTP 4 pair CAT 6 LAN Cable in the existing surface/ recessed Steel/ PVC conduit as required. 1 run of cable	Mtr.	125	
42	Supplying and fixing suitable size GI box with modular plate and cover in front on surface or in recess, including providing and fixing 3 pin 5/6 A modular socket outlet and 5/6 A modular switch, connections etc. as required.	Each	5	
43	Supplying and fixing suitable size GI box with modular plate and cover in front on surface or in recess, including providing and fixing 6 pin 5/6 & 15/16 A modular socket outlet and 15/16 A modular switch, connections etc. as required.	Each	5	
44	Supplying and fixing suitable size GI box with modular plate and cover in front on surface or in recess, including providing and fixing 2 nos. 3 pin 5/6 A modular socket outlet and 2 nos. 5/6 A modular switch, connections etc. as required. (For light plugs to be used in non residential buildings).	Each	5	
45	Supplying and drawing following sizes of FRLS PVC insulated copper conductor, single core cable in the existing surface/ recessed steel/ PVC conduit as required. a) 3 x 1.5 sq. mm	Mtr.	25	
	b) 3 x 2.5 sq. mm	Mtr.	50	
	c) 3 x 4 sq. mm	Mtr.	50	
46	Supplying and fixing of following sizes of steel conduit along with accessories in surface/recess including painting in case of surface conduit, or cutting the wall and making good the same in case of recessed conduit as required. a) 20 mm	Mtr.	150	
	b) 25 mm	Mtr.	50	
47	Providing and fixing 25 mm X 5 mm copper strip in 40 mm dia G.I. pipe from earth electrode including connection with brass nut, bolt, spring, washer excavation and re-filling etc. as required.	Mtr.	7	
48	Providing and fixing 25 mm X 5 mm copper strip on surface or in recess for connections etc. as required.	Mtr.	4	
49	Earthing with copper earth plate 600 mm X 600 mm X 3 mm thick including accessories, and providing masonry enclosure with cover plate having locking arrangement and watering pipe of 2.7 metre long etc. with charcoal/ coke and salt as required.	Set	1	
50	Supply of Aluminium, Armoured PVC insulated and PVC sheathed / XLPE LT power cable 4C of 16 square mm 1.1KV grade as per IS 7098 (Part-1) 1988 etc. as per requirement. Make: KEI, L&T, Havells, Polycab, Alcon	Mtr.	50	
51	Supplying & installation of C curve MCB TPN 63 Amp, 440V, 50Hz Make: L&T, Legrand, Havells, Standard	Nos.	3	
52	Supplying & fixing of High Flow wave Wall mounted Fan with minimum 450mm sweeps aerodynamically design, low noise 220V, 50Hz. Make: Crompton Greaves/Usha/ Orient/ Havells/Polycab	Nos.	14	

Contractor' sig.

Eng. In-charge

## Schedule of Quantities for Financial Bid

Sr. No.	Description of item	Unit	Qty	Rate (Rs.)	Amount (Rs.)
1	SMART DIGITAL PODIUM SITC of Smart Digital Podium - Consist of Controller for Projector On/Off and Motorised Screen Up/Down Cum Switcher for switching between PC/Laptop/Visualizer in the Podium for the output to the Screen. USB Port – for Pen Drive, Power Plug for Laptop. Comes with Desktop with Specifications are Processor i3 8th Gen, 4GB, 1TB HDD, Pre loaded Win 10 Pro & 22” Interactive Monitor with Motorised Angle Adjustment. with inbuild storage place under lock & key, space for Key/board mouse, Visualiser & Laptop with sliding top. With Cabling and Wiring Make: ALTOP/BRIO/ATDSC	Each	1		
2	UPS SITC of Back-UPS 6000VA With 16 X 26 AH Battery with Selectable Charger and Flooded/SMF Compatible Efficiency 92% (at 100% load). Crest Factor 3:1, Built-in Automatic Bypass, Power Chute Software. Input Frequency 40-70Hz. Input voltage for main operations 160-285V Make: EATON / VERTIV LIEBERT / APC	Each	1		
3	Projector RGB liquid crystal shutter projection system. Native XGA (1,024x768) resolution with 4000 lumens, 2 HDMI Ports. Auto power saving with brightness adjustment and lamp dimming, Wifi presentation with optional dongle, 2 years warranty Make: Sony/Panasonic/Epson	Each	2		
4	Projector Screen SITC of Motorized projector screen size 12ft*9ft Matt White Fabric, Tubular Motor, Octagonal Casing, with RF Remote Make: Liberty/Truvision/Lee Grand	Each	2		
5	Projector Mount kit SITC of 6ft Adjustable / Max. load Capacity - 8 kg / tilt: 15 degrees / Adjustable. Cable can be put through the drop pole. Make: Lee Grand/Liberty/ELCOR	Each	2		
6	20 Meter HDMI CABLE Supplying & Laying of HDMI version 1.4 male to male cable,24K gold plated connector resists High purity oxygen free copper conductor, Make: Honeywell / MX /Stecker	Each	1		
7	30 Meter HDMI CABLE Supplying & Laying of HDMI version 1.4 male to male cable,24K gold plated connector resists High purity oxygen free copper conductor, Make: Honeywell / MX /Stecker	Each	1		
8	25 Meter HDMI CABLE Supplying & Laying of HDMI version 1.4 male to male cable,24K gold plated connector resists High purity oxygen free copper conductor, Make: Honeywell / MX /Stecker	Each	1		

Contractor' sig.

Eng. In-charge

9	2 Meter HDMI CABLE Supplying & Laying of HDMI version 2.0 male to male cable,24K gold plated connector resists ,High purity oxygen free copper conductor. Make: Honeywell / MX /Stecker	Each	1		
10	HDMI Switcher Supplying & Fixing of HDMI 2 in 4 out Audio Switcher Make: Milestone/Kramer/Extron	Each	1		
11	SPEAKERS SITC of 80 Watt, Slim Column array with 16x1.5" driver YAMAHA/JBL/STUDIOMASTER	Each	2		
12	AMPLIFIER SITC of 2ch, 1050W with EQ, filter, crossover, delay Make: YAMAHA/CROWN/STUDIOMASTER	Each	1		
13	AMPLIFIER SITC of 2ch, 800W with EQ, filter, crossover, delay Make: YAMAHA/CROWN/STUDIOMASTER	Each	1		
14	CROSSOVER SITC of 2-WAY ACTIVE STEREO CROISSOVER. CROSSOVER SELECTABLE FREQUENCY : 60,90,120,200 & 280 Hz. Make: STUDIOMASTER	Each	1		
15	SubWoofer/Base SITC of 1020W, 12" powered Sub Woofer, 800 Watt Active Sub Woofer, 134 db peak Make: YAMAHA/JBL/STUDIOMASTER	Each	1		
16	STAGE MONITOR SITC of Stage monitor with 15" powered speaker, 2 way full range, FR 46 Hz - 20kHz Make: YAMAHA/JBL/STUDIOMASTER	Each	2		
17	MIXER SITC of 16 CH, 6 Mic/12 line input (4 mono + 4 stereo/2 griup buses+1 stereo bus/2 Aux) YAMAHA/SOUNDCRAFT/STUDIOMASTER	Each	1		
18	GOOSENECK MIC Supplying & Fixing of 21" Gooseneck MIC, Cardioid, Electret condenser, Frequeny Response - 20Hz-20KHz, Sensitivity - -40dB, Anti Mobile & RFTechnology Interference Make: AKG/STUDIOMASTER/SENNHEISER	Each	1		
19	WIRELESS MIC HANDHELD Supplying & Fixing of UHF Handheld Wireless Cardioid MIC, Frequeny Response - 50Hz-16KHz, Balanced XLR Unbalanced 1/4" Jack Make: AKG/STUDIOMASTER/SENNHEISER	Each	2		
20	WIRELESS MIC LAPEL Supplying & Fixing of UHF Lapel Wireless Cardioid MIC, Frequeny Response - 50Hz-16KHz, Balanced XLR Unbalanced 1/4" Jack Make: AKG/STUDIOMASTER/SENNHEISER	Each	6		
21	HEAD BAND Supplying & Fixing of Headset microphone, Uni-directional pick up pattern, Sensitivity -44 ± 2dB (6.3mV/Pa), Frequency Response 20Hz-20KHz, Nominal Impedence 2.2KΩ. Make: AHUJA/STUDIOMASTER/AKG	Each	6		
22	WIRED MIC Supplying & Fixing of Dynamic super-cardioid microphone for speech and vocals, Suspended cartridge shock-mount system, Frequency Response - 50Hz-15kHz, Sensitivity - -50dB ±3dB, Nominal Impedence 350 Ω Make: AKG/STUDIOMASTER/SENNHEISER	Each	6		

Contractor' sig.

Eng. In-charge



23	BRANDED MIC STAND Supplying & Fixing of Floor Stand, Powder Coated, Height 920-1500mm	Each	6		
24	SPEAKER WIRE - ROLLS Supplying & laying of 102/40 ABC 2/CORE Make: FALCON / KRYSTALS / KLOTZ	Roll	2		
25	ACCESSORIES Supplying & Fixing of Jack , Connector, Mic wire, uPVC trunking, stand for stage monitor & speakers Etc. as per requirement. Make: NEUTRIK/PPX/SR	Job	1		
26	Labor & Installation Charges	Job	1		
27	Providing and fixing aluminium work for doors, windows, ventilators and partitions with extruded built up standard tubular sections/ appropriate Z sections and other sections of approved make conforming to IS: 733 and IS: 1285, fixing with dash fasteners of required dia and size, including necessary filling up the gaps at junctions, i.e. at top, bottom and sides with required EPDM rubber/neoprene gasket etc. Aluminium sections shall be smooth, rust free, straight, mitred and jointed mechanically wherever required including cleat angle, Aluminium snap beading for glazing / paneling, C.P. brass / stainless steel screws, all complete as per architectural drawings and the directions of Engineer-in-charge. (Glazing, paneling and dash fasteners to be paid for separately) : For fixed portion Powder coated aluminium (minimum thickness of powder coating 50 micron)	KG	45		
28	For shutters of doors, windows & ventilators including providing and fixing hinges/ pivots and making provision for fixing of fittings wherever required including the cost of EPDM rubber / neoprene gasket required (Fittings shall be paid for separately) Powder coated aluminium (minimum thickness of powder coating 50 micron)	KG	12		
29	Providing and fixing 12 mm thick pre-laminated particle board flat pressed three layer or graded wood particle board conforming to IS: 12823 Grade I Type II, in panelling fixed in aluminium doors, windows shutters and partition frames with C.P. brass / stainless steel screws etc. complete as per architectural drawings and directions of engineer-in-charge. Pre-laminated particle board with decorative lamination on both sides	Sqm	1.48		
30	Providing and fixing glazing in aluminium door, window, ventilator shutters and partitions etc. with EPDM rubber / neoprene gasket etc. complete as per the architectural drawings and the directions of engineer-in-charge . (Cost of aluminium snap beading shall be paid in basic item): With float glass panes of 5 mm thickness (weight not less than 12.50 kg/ sqm)	Sqm	2.25		
31	Providing and fixing Brass 100mm mortice latch and lock with 6 levers without pair of handles (best make of approved quality) for aluminium doors including necessary cutting and making good etc. complete.	Each	1		

Contractor' sig.

Eng. In-charge

32	Providing and fixing aluminium tower bolts, ISI marked, anodised (anodic coating not less than grade AC 10 as per IS : 1868 ) transparent or dyed to required colour or shade, with necessary screws etc. complete 150x10 mm	Each	2		
33	Providing and fixing aluminium hanging floor door stopper, ISI marked, anodised (anodic coating not less than grade AC 10 as per IS : 1868) transparent or dyed to required colour and shade, with necessary screws etc. complete. Twin rubber stopper	Each	1		
34	Supplying and laying of following size DWC HDPE pipe ISI marked along with all accessories like socket, bend, couplers etc. conforming to IS 14930, Part II complete with fitting and cutting, jointing etc.direct in ground (75 cm below ground level) including excavation and refilling the trench but excluding sand cushioning and protective covering etc., complete as required. 63 mm dia (OD-63 mm & ID-51 mm nominal)	Mtr.	50		
35	Laying of one number PVC insulated and PVC sheathed / XLPE power cable of 1.1 KV grade of following size in the existing RCC/ HUME/ METAL pipe as required. Upto 35 sq. mm	Mtr.	50		
36	Providing and fixing following rating and breaking capacity and pole MCCB with thermomagnetic release and terminal spreaders in existing cubicle panel board including drilling holes in cubicle panel, making connections, etc. as required. 100 A, 16 KA,TPMCCB	Each	1		
37	Supplying and fixing following way, horizontal type three pole and neutral, sheet steel, MCB distribution board, 415 V, on surface/ recess, complete with tinned copper bus bar, neutral bus bar, earth bar, din bar, interconnections, powder painted including earthing etc. as required. (But without MCB/RCCB/Isolator) 4 way (4 + 12), Double door	Each	2		
38	Supplying and fixing 5 A to 32 A rating, 240/415 V, 10 kA, "C" curve, miniature circuit breaker suitable for inductive load of following poles in the existing MCB DB complete with connections, testing and commissioning etc. as required. a) Single pole	Each	24		
	b) Double pole	Each	1		
39	Supplying and fixing 30 A, 415 V, TPN Industrial type socket outlet, with 4 pole and earth, metal enclosed plug top alongwith 30 A "C" curve, TPMCB, in sheet steel enclosure, on surface or in recess, with chained metal cover for the socket out let and complete with connections, testing and commissioning etc. as required.	Each	2		
40	Supplying and fixing DP sheet steel enclosure on surface/ recess along with 25/32 A 240 V "C" curve DP MCB complete with connections, testing and commissioning etc. as required.	Each	3		
41	Supplying and drawing of UTP 4 pair CAT 6 LAN Cable in the existing surface/ recessed Steel/ PVC conduit as required. 1 run of cable	Mtr.	125		

Contractor' sig.

Eng. In-charge

42	Supplying and fixing suitable size GI box with modular plate and cover in front on surface or in recess, including providing and fixing 3 pin 5/6 A modular socket outlet and 5/6 A modular switch, connections etc. as required.	Each	5		
43	Supplying and fixing suitable size GI box with modular plate and cover in front on surface or in recess, including providing and fixing 6 pin 5/6 & 15/16 A modular socket outlet and 15/16 A modular switch, connections etc. as required.	Each	5		
44	Supplying and fixing suitable size GI box with modular plate and cover in front on surface or in recess, including providing and fixing 2 nos. 3 pin 5/6 A modular socket outlet and 2 nos. 5/6 A modular switch, connections etc. as required. (For light plugs to be used in non residential buildings).	Each	5		
45	Supplying and drawing following sizes of FRLS PVC insulated copper conductor, single core cable in the existing surface/ recessed steel/ PVC conduit as required. a) 3 x 1.5 sq. mm	Mtr.	25		
	b) 3 x 2.5 sq. mm	Mtr.	50		
	c) 3 x 4 sq. mm	Mtr.	50		
46	Supplying and fixing of following sizes of steel conduit along with accessories in surface/recess including painting in case of surface conduit, or cutting the wall and making good the same in case of recessed conduit as required. a) 20 mm	Mtr.	150		
	b) 25 mm	Mtr.	50		
47	Providing and fixing 25 mm X 5 mm copper strip in 40 mm dia G.I. pipe from earth electrode including connection with brass nut, bolt, spring, washer excavation and re-filling etc. as required.	Mtr.	7		
48	Providing and fixing 25 mm X 5 mm copper strip on surface or in recess for connections etc. as required.	Mtr.	4		
49	Earthing with copper earth plate 600 mm X 600 mm X 3 mm thick including accessories, and providing masonry enclosure with cover plate having locking arrangement and watering pipe of 2.7 metre long etc. with charcoal/ coke and salt as required.	Set	1		
50	Supply of Aluminium, Armoured PVC insulated and PVC sheathed / XLPE LT power cable 4C of 16 square mm 1.1KV grade as per IS 7098 (Part-1) 1988 etc. as per requirement. Make: KEI, L&T, Havells, Polycab, Alcon	Mtr.	50		
51	Supplying & installation of C curve MCB TPN 63 Amp, 440V, 50Hz Make: L&T, Legrand, Havells, Standard	Nos.	3		
52	Supplying & fixing of High Flow wave Wall mounted Fan with minimum 450mm sweeps aerodynamically design, low noise 220V, 50Hz. Make: Crompton Greaves/Usha/ Orient/ Havells/Polycab	Nos.	14		

- The Contractors should quote in figures as well as in word the rates and amount tendered by them. The amount for each item should be worked out the requisite totals given.
- An item rate tender containing percentage below/above will be summarily rejected. However where a quotation voluntarily offers a rebate, this may be considered.
  - Quotations shall be strictly as per the condition of work, conditional quotations are liable to be rejected.
- Special care should be taken to write the rate and amounts in figures as well as in words in such a way that interpolation is not possible. The total amount should be written before the figure of Rupees and word paisa should be written at the end (unless the rates in whole rupees) and followed by the word only. It should invariably to upto two decimal places. While quoting the rates in schedule of quantities, the word only should be written closely following the amount and it should not be written in the next line.

**Contractor' sig.**

**Eng. In-charge**

- ii) In case of any discrepancy between the rates quoted in figures and words that rate on which the amount has been worked out shall be taken as correct. In case of any discrepancy between the rate quoted and the amount worked out the rate quoted in figures and words shall be taken as correct.
4. The quotation for works shall remain open for acceptance for a period of ninety days from date of opening of tenders. If any contract withdraws his quotation before the said period or makes any modification in the terms and conditions of the quotation which are not acceptable to the Institute.
  5. The acceptance of a tender will rest with the Director, SLIET who does not bind himself to accept the lowest quotation, and reserves to himself the authority to reject any or all of the quotations received without the assignment of any reason. All quotations in which any of the prescribed conditions are not fulfilled or are incomplete in any respect are liable to be rejected.
  6. On acceptance of the quotation, the name of the accredited representative(s) of the contractor who would be responsible for taking instructions from the Engineer-in-charge shall be intimated to the undersigned.
  7. **Security Deposit**  
10% will be deducted from each RA bill of contractor as a security deposit subject to maximum 5% of the contract value. This will be released after satisfactory completion of defect liability period (which is one year from the date of completion of work) & completion of all contractual obligations, submission of relevant complete documents and NOC from Labour Commissioner.  
  
In case contractor claims first & final bill, the bidder has to submit performance security @5% of contract value subject to minimum 5000/- in the form of BG/FD/DD favouring Director SLIET Longowal valid upto defect liability period. This will be release after satisfactory completion of defect liability period and completion of all contractual obligations on the submission of all relevant documents.
  8. The EMD shall be refunded to the successful bidder beyond 60 days after the successful completion of work upto the entire satisfaction of Engineer In-Charge & on the submission of Performance Security/Security Deposit whichever is earlier.
  9. The contractor shall also ensure compliance of the EPF & MP Act, 1952 by the Sub-contractor, if any engaged by the contractor for the said work and any sub-contractor engaged should also have Provident Fund Code.
  10. Canvassing in connection with quotation is strictly prohibited and the quotation submitted by the contractors who resort to canvassing will be liable to rejection.
  11. The Contractor shall not be permitted to quotation for work in the SLIET responsible for award and execution of contractors in which his near relative is posted as Accountant or as an Officer in any capacity between the grades of Faculty In-charge (Electrical) and Assistant Engineer (both inclusive). He shall also intimate the names of persons who are working with in any capacity or are subsequently employed by him and who are near relatives to any of the officers in the Institute. Any breach of this condition by the Contractor would render him liable to be removed from the approved list of contractors of this Institute.
  12. GST or any other tax on material in respect of the contract shall be payable by the contractor and Institute will not entertain any claim whatsoever.
  13. In case of non-availability of ESIC Scheme in the region, the same shall be covered under the Workman Compensation Act (WCA) or Group Insurance Scheme by the Contractor.
  14. The payment will be made within 30 days after completion of work & on the submission of Tax invoice with GST no, RTGS/NEFT bank detail & other relevant documents (if any) subject to the fully satisfaction of the department about the quality of work.

**Contractor' sig.**

**Eng. In-charge**

**Drawing**

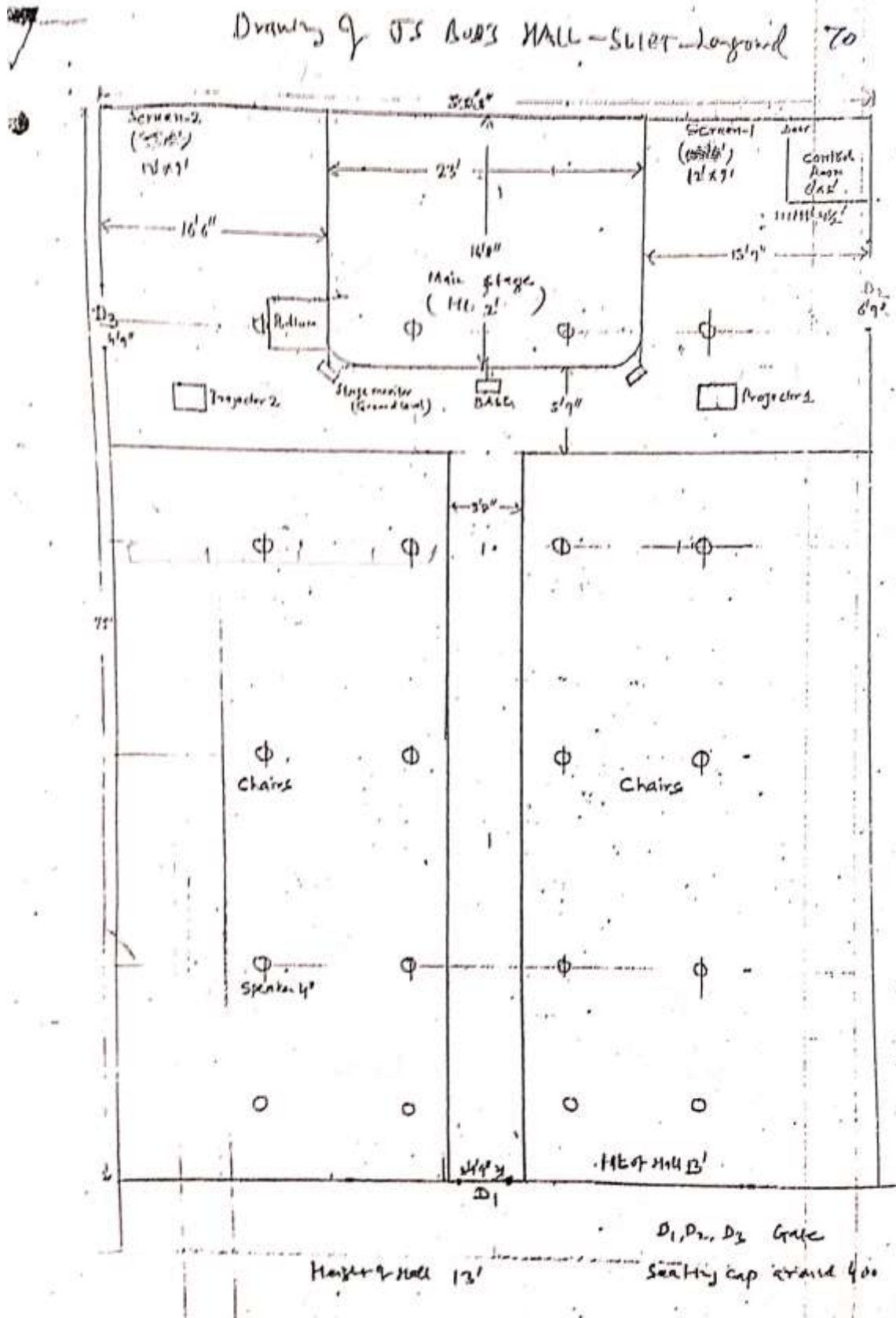

15.

Contractor' sig.

Eng. In-charge